

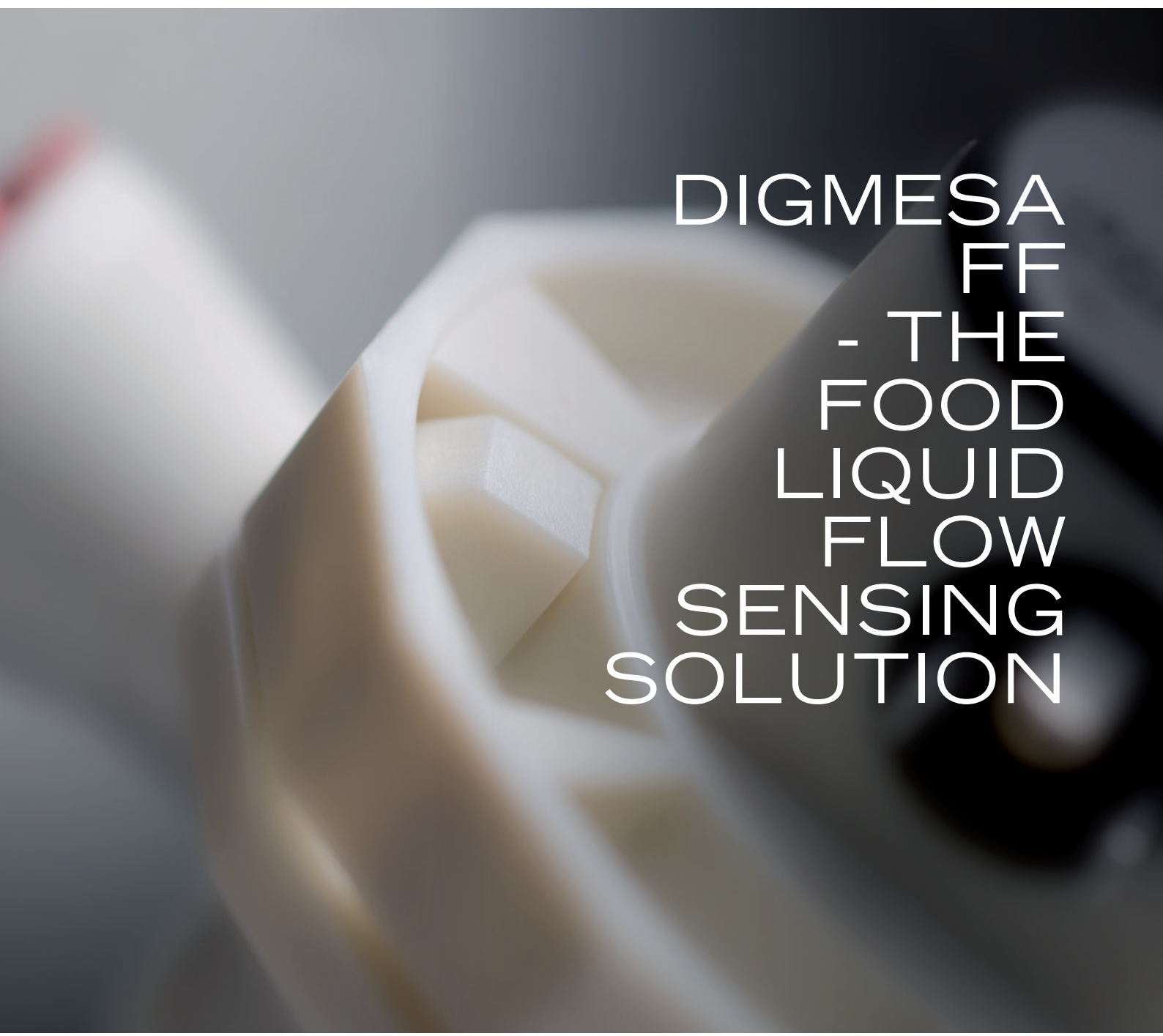

WWW.TEESING.COM

A close-up, slightly blurred photograph of a white plastic component, likely a valve or sensor, with a central opening and a textured surface. The background is dark and out of focus.

DIGMESA
FF
- THE
FOOD
LIQUID
FLOW
SENSING
SOLUTION

DIGMESA[®]
A WORLD OF FLOW

WWW.TEESING.COM | +31 70 413 07 00

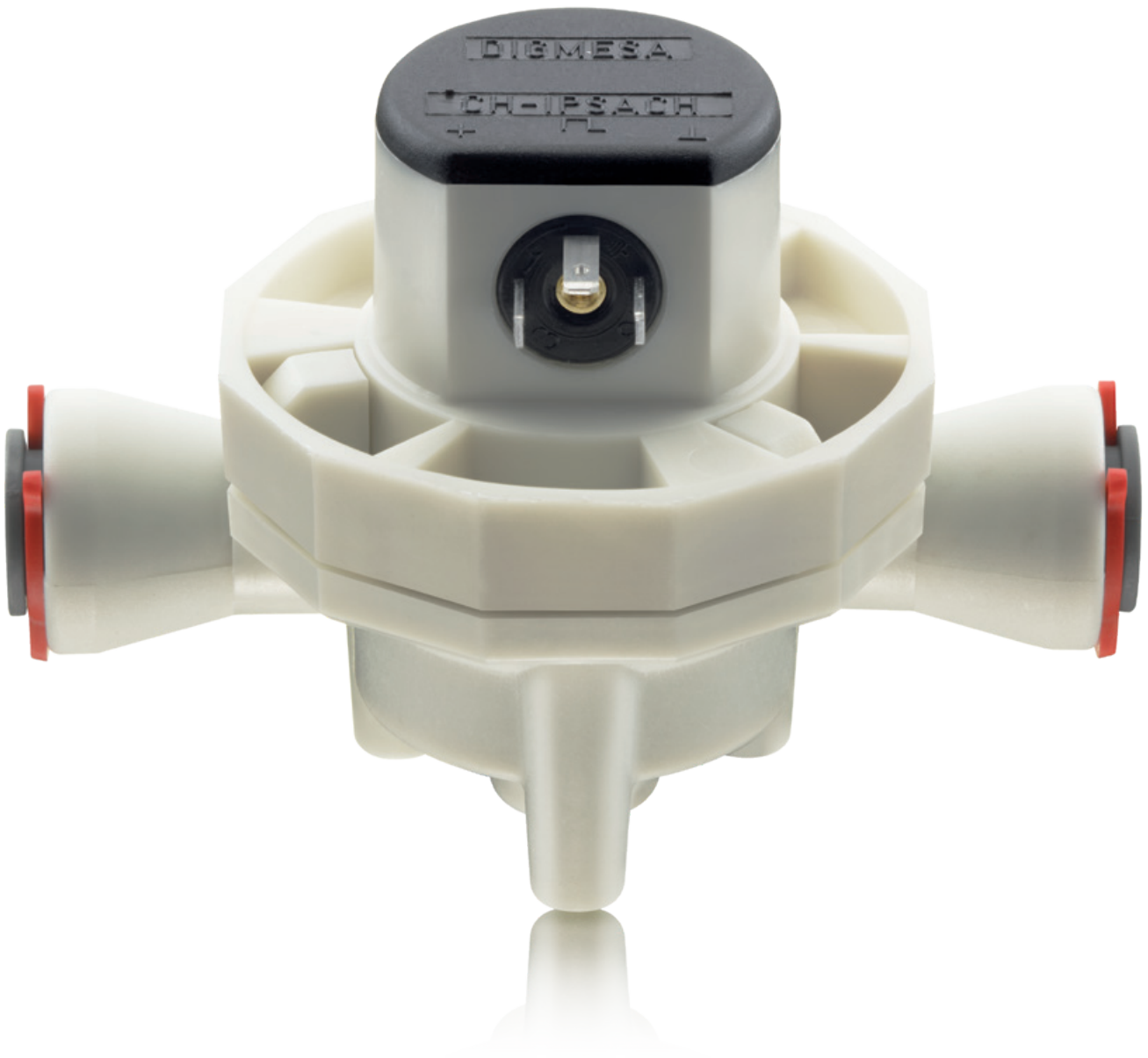



Flow Sensor FF Technical Information

Imagine it's match break. The order arrives: 50,000 beers, please! Here, when connected in series for simultaneous beer dispensing, the Classicline FF provides an outstanding solution. It was the first flow sensor in Germany to obtain SK certification for beer and is now a top seller. It can be opened without any tools for easy cleaning. The version with a jewel bearing allows the mounting position to be chosen freely. Moreover, with the optional integrated foam probe, it measures only the actual amount of liquid that has been transferred. This prevents errors caused by carbonated gas when the line is empty.

Flow Rate l/min

Nozzle	Min	Max
4.0 mm	0.22	7.75
5.0 mm	0.34	11.50
6.0 mm	1.46	16.20

Output Signal

Pulse

Material

PBT (Fiberglass Reinforcement), PVDF

Application examples

Beverages, sparkling fermented beverages foam detection only available in PBT (Fiberglass Reinforcement)



FF STD

FF Premium

FF Chemistry

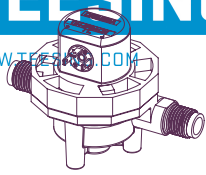

PBT (Fiberglass Reinforcement)

STD

STD

–

PVDF

–

–

STD

Process Connection

FFC 40 BSF 1/2" cola m/m (nozzle Ø 4.0 mm)

STD

STD

–

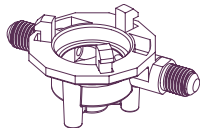

FFP 50 UNF 7/16" pepsi m/m (nozzle Ø 5.0 mm)

•

•

–

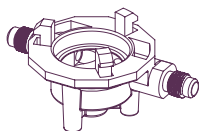

FFG 40 G1/4" m/m (nozzle Ø 4.0 mm)

•

•

–

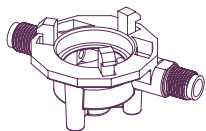

FFG 60 G1/4" m/m (nozzle Ø 6.0 mm)

•

•

STD

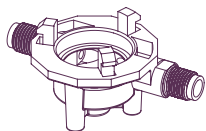

FFJ JG 3/8" f/f (nozzle Ø 5.0 mm)

•

•

–

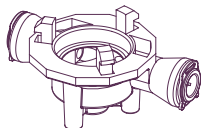

FFB 50 G5/8" m/f (nozzle Ø 5.0 mm)

–

•

–

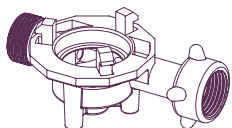

FFB2 50 G5/8" m/m (nozzle Ø 5.0 mm)

•

•

–

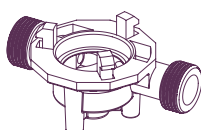

WWW.TEESING.COM

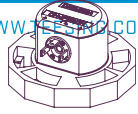

3 pin amp

STD

STD

STD

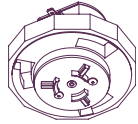

3 pin amp SM

•

•

–

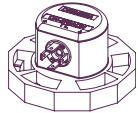

O-Ring

Silicon

STD

STD

–

FPM

•

•

STD

EPDM

•

•

•

Turbine

PVDF Low 2M (wetted magnets)

STD

–

–

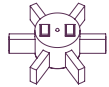

PVDF Low 4M (wetted magnets)

•

–

–

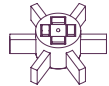

PVDF / Ruby 2M (sealed magnets)

–

STD

–

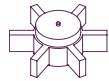

PVDF Chem. 2M (sealed magnets)

–

–

STD

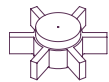

PVDF Chem. 4M (sealed magnets)

–

–

•

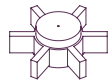

Bearing Pin

Low bearing pin Inox 1.4305

STD

–

–



Rubin bearing pin Inox 1.4404 / Rubin

–

STD

–



Chem. bearing pin PCTFE

–

–

STD





WWW.TEESING.COM

DIGMESA INTERNATIONAL LTD.
BACHSTRASSE 3
6362 STANSSTAD
SWITZERLAND

WWW.DIGMESA.COM
INFO@DIGMESA.COM

All measurements have been taken under ideal laboratory conditions.

WWW.TEESING.COM | +31 70 413 07 00